



CONVI CLAMP

The Convi clamp, made of aluminum cast alloy, can be securely mounted on any tube from 5 to 51mm and equipped with a saddle for mounting onto flat surfaces. The elastic P.U. Pad also reduces surface damage and enhances gripping action. All metal parts are made of stainless steel for sturdier and anti-rusted features. The die -casting aluminum of locking knob provides with most rugged advantage. With built-in female socket allows the use of any attachments to hold anything from backgrounds to lighting fixtures. The spring safety locking system also offers double insurance while the screw locking action is not completely finished.



KCP-700B Convi Clamp-Black

KCP-700P Convi Clamp-Silver

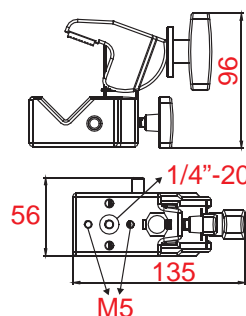

KCP-710B Convi Clamp w/Adjustable Handle-Black

KCP-710 Convi Clamp w/Adjustable Handle-Silver



KCP-720B Double Convi Clamp-Black

KCP-720 Double Convi Clamp-Silver



Application



KD-730B Convi Clamp Double Socket-Black

KD-730 Convi Clamp Double Socket-Silver

Offer an additional 5/8" (16mm) socket to Convi clamp



KCP-7SDL Convi Clamp Saddle

Allow to use the clamp on most flat surfaces such as a table without tool.
Set for four.



KS-019 Swivel Extension Arm w/5/8" Receiver



KS-018
5/8" (16mm)
Stud w/M10 thread



KS-004
M12 x 60 Stud



KS-005
M10 x 25 Stud

